

MotorGuide® REPAIR PARTS

Model:
ST350V

SPECIFICATIONS:

| | |
|----------|--------------|
| Year | 1996 |
| Thrust | 41LBS |
| Volts | 12VDC |
| Amp Draw | 0 to 48 amps |
| Mount | 03 |
| Speeds | Variable |

PARTS ORDERING & TECH ASSISTANCE

MotorGuide Consumer Relations
Phone 918-831-6989
Fax 800-982-8093

Send Returned Goods to:

MotorGuide
605 Hwy 12 West
Starkville, MS 39760

Returned Goods must be accompanied with a Returned Goods Authorization. Contact MotorGuide Consumer Relations to obtain RGA.

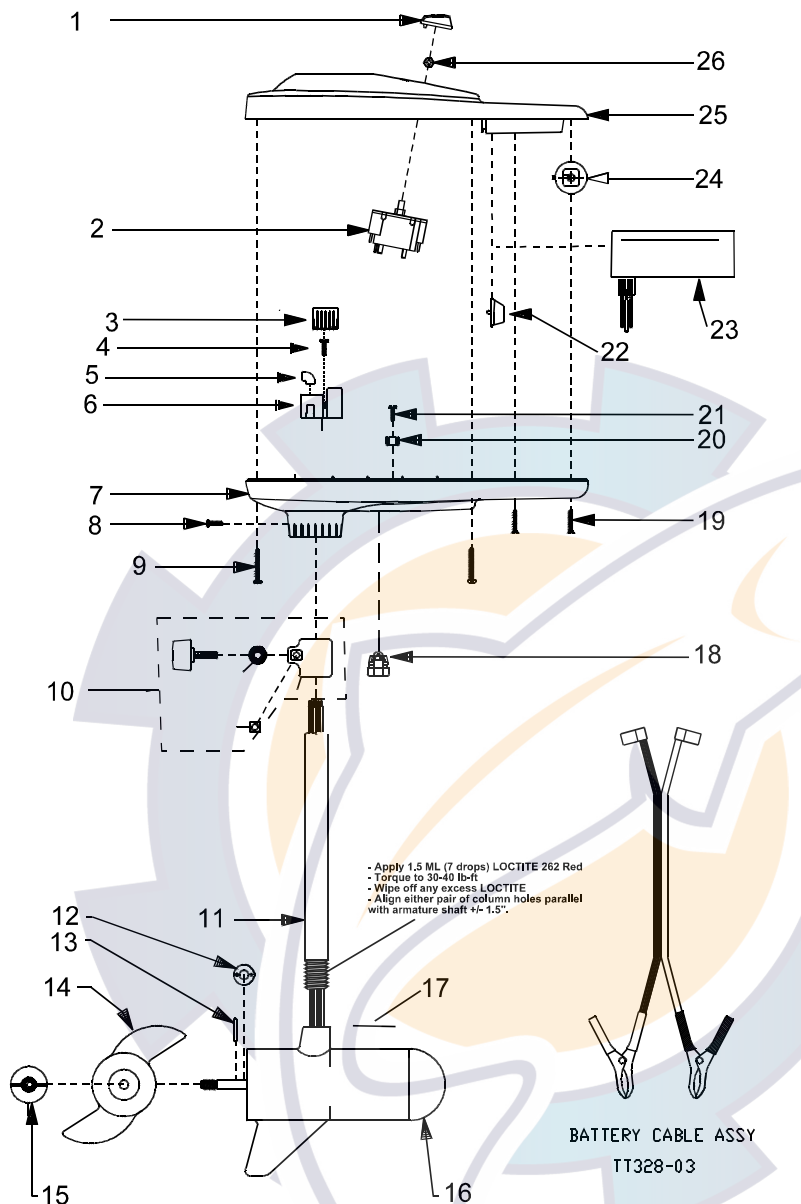

| KEY | DESCRIPTION | PART # |
|-----|-------------------------|-----------|
| 1 | KNOB | TT082-03 |
| 2 | ROTARY SWITCH | KT150-02 |
| 3 | AMP CONNECTOR | AP029-01 |
| 4 | SCREW | AF141-01 |
| 5 | INSULATOR | AT080-01 |
| 6 | DA BOARD | JF157-03 |
| 7 | T/H BASE | TF004-04 |
| 8 | 8 X 1-3/8 SCREW | AR133-01 |
| 9 | 8 X 1-3/8 SCREW | AR133-01 |
| 10 | DEPTH COLLAR ASY | AR158-01 |
| 11 | 30" COLUMN | TT049-01 |
| 12 | MONOFILAMENT WASHER | AR175-01 |
| 13 | PROP DRIVE PIN | BR102-01 |
| 14 | PROP | AF124-10 |
| 15 | PROP NUT | AR099-01 |
| 16 | MOTOR | CF397-05 |
| 17 | MARINE LOWER UNIT DECAL | ET060-04 |
| 18 | GROMMET | GR019-03 |
| 19 | #4x 1" SCREW | TT141-02 |
| 20 | TERMINAL | FT160-03 |
| 21 | #10x 1/2" SCREW | GR133-01 |
| 22 | POT ACTUATOR | TT3001-02 |
| 23 | SLIDE POTENTIOMETER | TT168-03 |
| 24 | ON/OFF HANDLE ASSY | TT372-01 |
| 25 | T/H COVER | KT053-11 |
| 26 | NUT | AT098-01 |

LOWER UNIT BREAKDOWN

Model:
ST350V

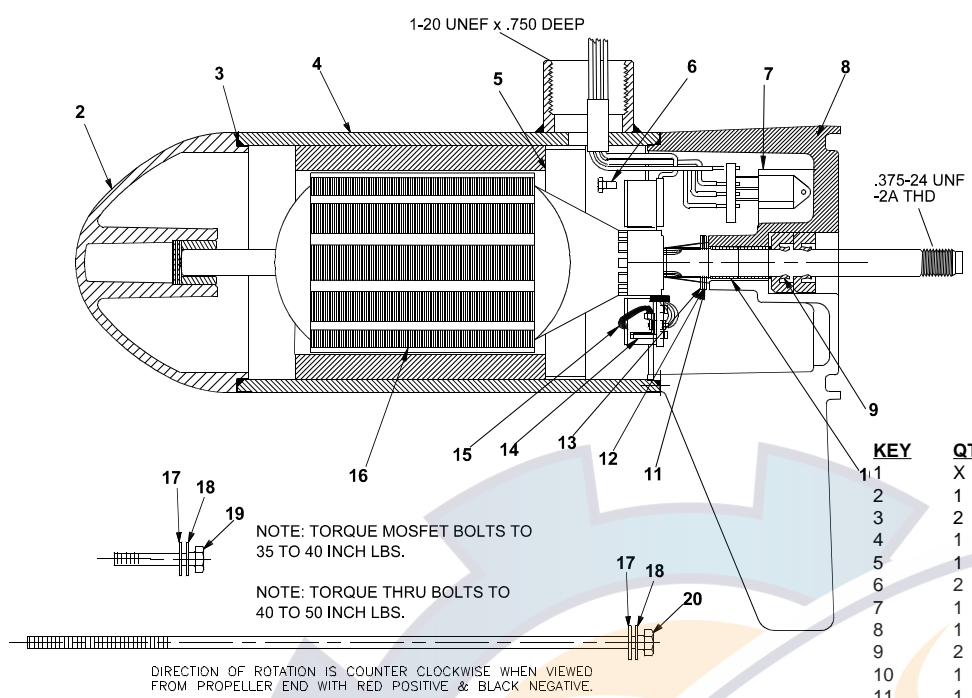

NOTE: TORQUE MOSFET BOLTS TO 35 TO 40 INCH LBS.
NOTE: TORQUE THRU BOLTS TO 40 TO 50 INCH LBS.

DIRECTION OF ROTATION IS COUNTER CLOCKWISE WHEN VIEWED FROM PROPELLER END WITH RED POSITIVE & BLACK NEGATIVE.

| KEY | QTY | DESCRIPTION | PART NO. |
|-----|-----|-----------------------|-----------|
| 1 | X | MOTOR | CF397-05 |
| 2 | 1 | NOSE CAP | JF3212-01 |
| 3 | 2 | O RING SEAL | MR217-01 |
| 4 | 1 | HOUSING ASY | JF3210-01 |
| 5 | 1 | RETAINER | JF233-01 |
| 6 | 2 | BRUSH CARD SCREW | MR228-01 |
| 7 | 1 | DURA AMP MODULE | JF096-07 |
| 8 | 1 | COMM CAP | JF3205-04 |
| 9 | 2 | SHAFT SEAL | MR223-01 |
| 10 | 1 | BEARING | MR206-01 |
| 11 | 1 | NYLATRON WASHER | MR226-01 |
| 12 | 1 | WASHER | MR227-01 |
| 13 | 1 | E RING | MR219-02 |
| 14 | 2 | BRUSH SPRINGS | MR214-02 |
| 15 | 1 | BRUSH ASY LESS SPRING | JF3201-03 |
| 16 | 1 | ARMATURE 3.5" | CF3207-01 |
| 17 | 4 | STATIC SEAL | MR222-01 |
| 18 | 4 | THRU BOLT WASHER | MR216-01 |
| 19 | 2 | DURA AMP SCREW | MR229-04 |
| 20 | 2 | THRU BOLT | MR218-02 |

WIRING

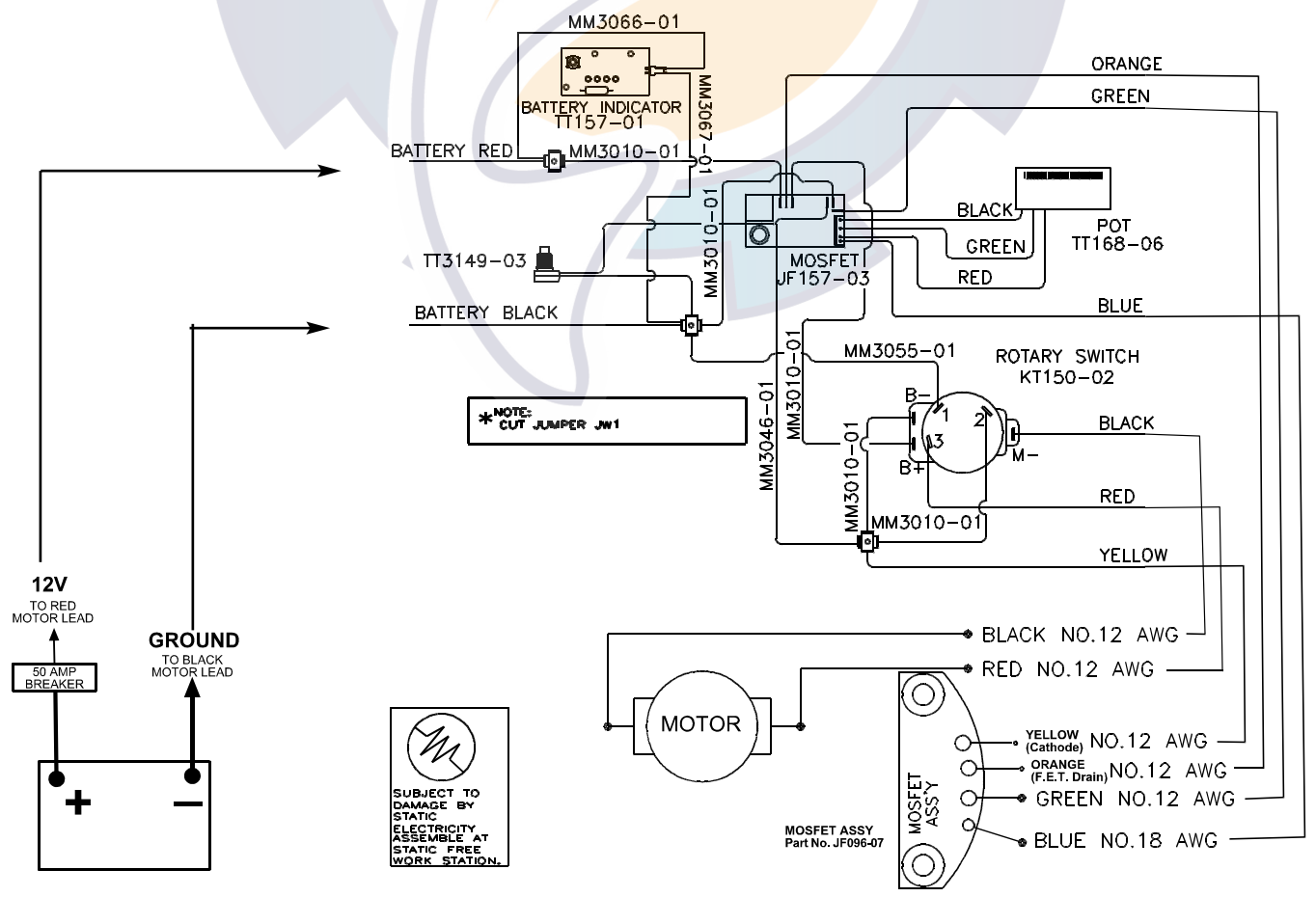

*NOTE: CUT JUMPER JW1

SUBJECT TO DAMAGE BY STATIC ELECTRICITY ASSEMBLE AT STATIC FREE WORK STATION.

MOSFET ASSY Part No. JF096-07